



A new kind of fire suppression system



شرکت مهندسی اردال
ARDAL ENGINEERING CO.

Rotarex Fire DETEC®, it is Extinguishing System and a Detection System as well, it is an Automatic Extinguishing System Suitable for Various applications.
The Extinguishing System and a Detection System are coupled together in a way that minimizes any mistakes in the Detection and make the Automatic Extinguishing as reliable as it can be.

Working Principle:

Rotarex Fire DETEC® systems use a proprietary continuous linear sensor tube that reliably detects and actuates release of the extinguishing agent using pneumatic technology. It is more flexible, space efficient and cost effective versus alternative mechanical or electronic systems.

The revolutionary pneumatic design enables cost-effective protection of individual high-risk areas like electrical and mechanical equipment that were previously not practical to protect.

1. Installation closer to the source
2. Early fire detection
3. Instant Suppression

Choice of configuration



INDIRECT SYSTEM

Extinguishing agent is discharged through a separate delivery nozzle.

Used for:

All Enclosed spaces < 9m³

Advantages:

- Most effective fire suppression
- Covers a large area
- Allows quicker discharge of extinguishing agent
- Multiple nozzle delivery options such as foaming and wide dispersion
- Works with all suppression agents

DIRECT SYSTEM

Extinguishing agent is discharged through the burst hole in the sensor tube.

Used for:

Very small enclosed space and hard to reach areas

Advantages:

- More economical
- Easiest-to-install

Applications

Electrical Cabinets

- Electrical Cabinets
- Control Boxes
- Recharging stations
- Switch panels
- Relay stations

Oils, chemicals and open flame

- Fume Cabinet
- Paint & Chemical storage cabinets
- Petroleum storage tanks
- Hydraulic circuits

Many other applications:

- CNC Machinery
- Diesel Generators
- Wind Turbines
- Construction Cranes
- Pumping Station
- Medical Laboratory Equipment
- Cable Ducts
- Transmitters



FIREDETEC SENSOR TUBE: (Detection Tube)



Description	ALL PURPOSE TUBING Engineered for most Applications	HEAVY DUTY TUBING Special multi-layer Construction is more Resistant to temperature extremes	PROTECTIVE STEEL SPRING Material Stainless Steel
Outside Diameter	0.234" / 6 mm	0.234" / 6 mm	-
Inside Diameter	0.156" / 4 mm	0.156" / 4 mm	-
Color	Red RAL 3000	Red RAL 3000	-
Min. bend radius	4" / 100 mm	5.9" / 150 mm	-

End of Line Devices



END OF LINE ADAPT	MANUAL RELEASE Device	SOLENOID RELEASE Device	End of Line Plug	Filling Adaptor
-------------------	-----------------------	-------------------------	------------------	-----------------

Nozzles



Product code	026200107	026200116	B06960000	B06960002
Orifice	8 x 2 mm	3 holes x 2 mm	Dispersion cone	Directional cone
Extinguishing agents	HFC-227ea	CO2 and inert gas	CO2 and inert gas	CO2 and inert gas
Connection	1/2" NPT	G 1/4 female	W 21,8 x 1/14 female	W 21,8 x 1/14 female
Material	Raw Brass	Stainless Steel 303	PE & Steel	PE & Steel

Over View of a typical Indirect System

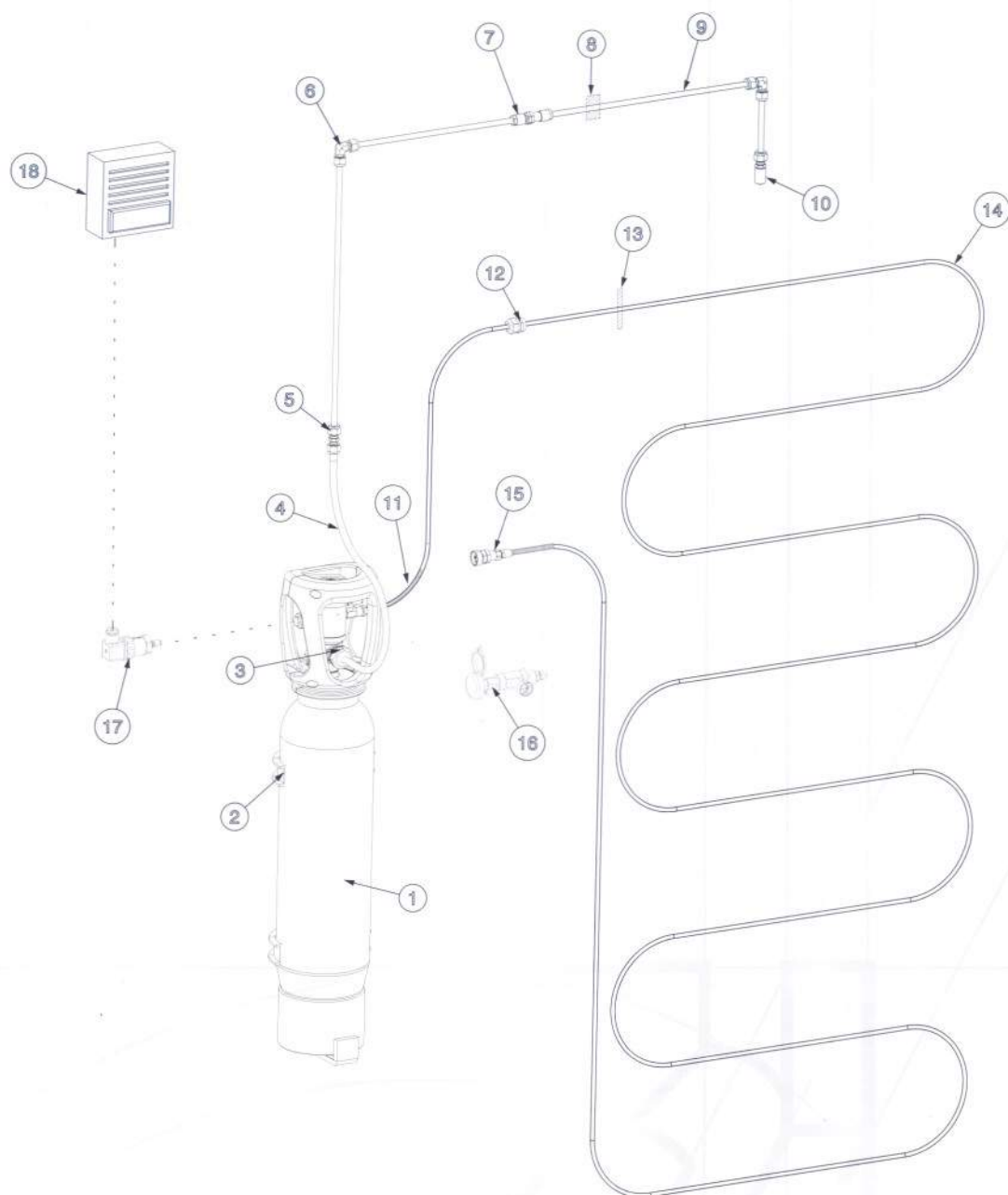

POS.	Qty	Description	POS.	Qty	Description
1	1	IKP Kit -2/5/10 KG	10	1	Nozzle
2	1	Cylinder Bracket	11	1	Spring Top
3	1	Gasket	12	1	Cross panel Fitting
4	1	Flexible Piping	13	20	Cable Ties
5	2	Tube Fitting	14	1	Fire DETEC Tube RED
6	2	Tube Fitting - Elbow	15	1	End of Line Adapter
7	1	Cross Panel Fitting	16	1	Manual Release Device
8	4	Pipe Bracket (Ø 8mm)	17	1	Pressure Switch
9	2	Stainless Steel Pipe	18	1	Alarm Box

Integrated Fire Safety and Security Solutions



شرکت مهندسی اردال
ARDAL ENGINEERING CO.

تهران، خیابان خالد اسلامبولی، خیابان پنجم، پلاک ۲۳
تلفن: ۸۸۷۱۰۸۰۹-۱۰ ، ۸۸۷۲۷۰۹۱-۲
کد پستی: ۱۹۳۳۴-۱۵۱۳۷ فاکس: ۸۸۷۲۷۱۶۷

NO.23 , Fifth St. , Khalid Islamboli Ave.
Tehran 15137-19334 – Iran Fax:(+9821) 88727167
Tel:(+9821) 88710809-10 , (+9821) 88727091-2

www.ardalengineering.com
info@ardalengineering.com
ardal@dpimail.net